



1/41A Sheffield Street Malvern SA

2  1  1 

This solid brick maisonette is surprisingly spacious and full of natural light. Comprising 2 living areas, main bedroom with walk in robe, updated bathroom with separate WC plus separate laundry. Other features include 4 split system air conditioners, secure garage with direct access via the courtyard and space for an additional car off street.

Enjoy the lovely outdoor spaces including the walled front garden, easterly courtyard and the established, very private and secure rear garden. Perfect for entertaining or quiet enjoyment.

Brilliant entry point for down sizers, first home buyers and investors alike, in this blue chip near city location.

Council rates: \$1,278.05 pa

Price : \$ 635,000
Building Size : 280 sqm
View : <https://www.foxrealestate.com.au/property/141a-sheffield-street-malvern-sa/5739815>



Edwina Lehmann
08 8267 4995



Candy Bennett
08 8267 4995

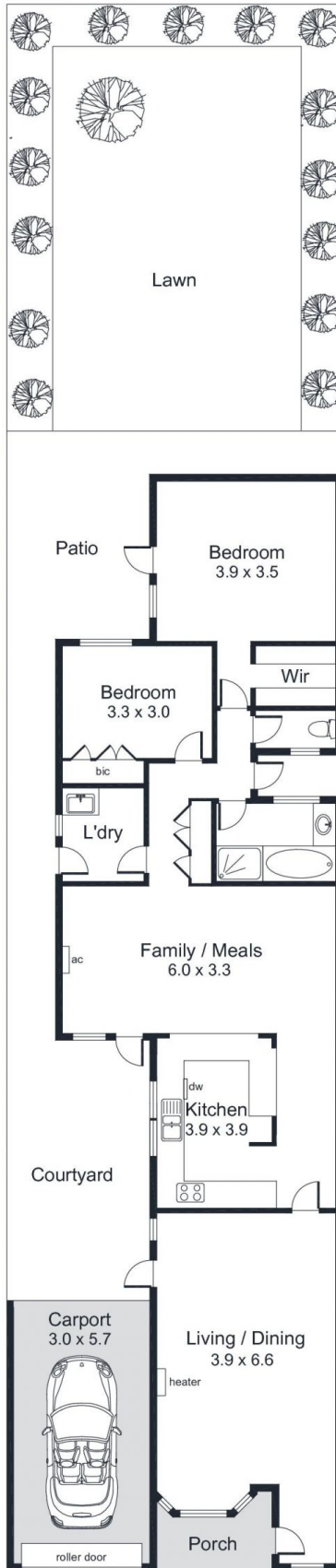

Area (Estimate only)	
Living	106.0 m ₂
Carport	17.0 m ₂
Porch	3.4 m ₂
Total	126.4 m₂

For illustrative purposes only.
All measurements are approximate