



36 Hocking Street Brompton SA

2  1  1 

Expressions of Interest Closing | 5pm Wednesday 27 March 2024 (Unless sold prior)

Brompton is an historic near city suburb adjacent Bowden which is rapidly evolving through gentrification. Adelaide's original bohemian area, it is an eclectic gem of a suburb with an exciting future.

Offered for the first time since being constructed approximately 10 years ago, this contemporary take on an original workers cottage enjoys two(2) street frontages and has the preferred northern aspect to the rear.

Presently the decor is a neutral palette, not yet a "bohemian rhapsody" but destined to respond well to an injection of your own personality.

Land Size : 143 sqm
View : <https://www.foxrealestate.com.au/property/36-hocking-street-brompton-sa/7937909>



Mark Conway
08 8267 4995

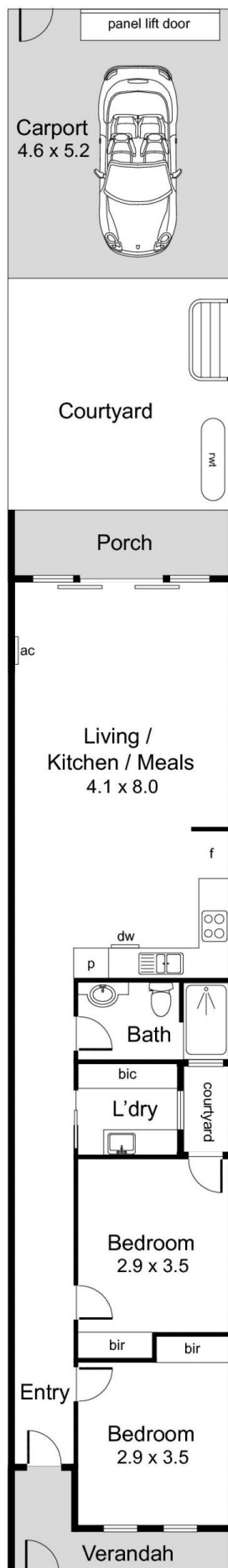

Area (Estimate only)	
Living	85.1 m ₂
Verandah	4.0 m ₂
Porch	5.3 m ₂
Carport	23.9 m ₂
Total	118.3 m₂

For illustrative purposes only.
All measurements are approximate