



## 99 Palmer Place North Adelaide SA

3  3  4 

Expressions of Interest close Wednesday 27th May at 12pm.

PHONE FOR SATURDAY AND MONDAY INSPECTION TIMES.

Perfectly positioned in one of North Adelaide's most tightly held enclaves, this magnificent residence of extraordinary proportions on 2 levels with stunning outlooks to the green expanse of Palmer Gardens.

First time on the market in nearly 40 years, the home has been masterfully reimaged to deliver a rare fusion of timeless character and sophisticated contemporary living.

[For full version visit the website](https://www.foxrealestate.com.au)

**Type** : House  
**Price** : Contact Agent  
**Land Size** : 1363 sqm  
**View** : <https://www.foxrealestate.com.au/property/99-palmer-place-north-adelaide-sa/8696693>



**Candy Bennett**  
08 8267 4995



**Andrew Fox**  
08 8267 4995

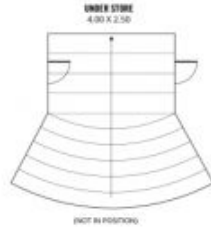
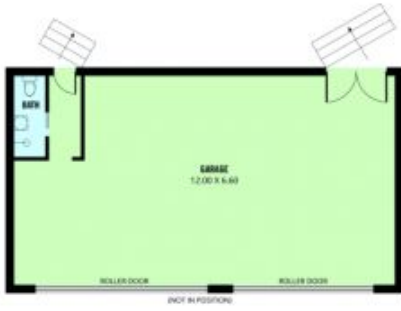

**99 PALMER PLACE, NORTH ADELAIDE**

884m <sup>2</sup>	495m <sup>2</sup>	140m <sup>2</sup>	79m <sup>2</sup>	137m <sup>2</sup>	33m <sup>2</sup>
<b>TOTAL</b>	Living	Verandah/ Patio	Garage	Pergola/ Courtyard	Undercover Entertaining

Scale in metres. This drawing is for illustration purposes only. All measurements are approximate and details intended to be relied upon should be independently verified.



Produced by The Flatbase Group